

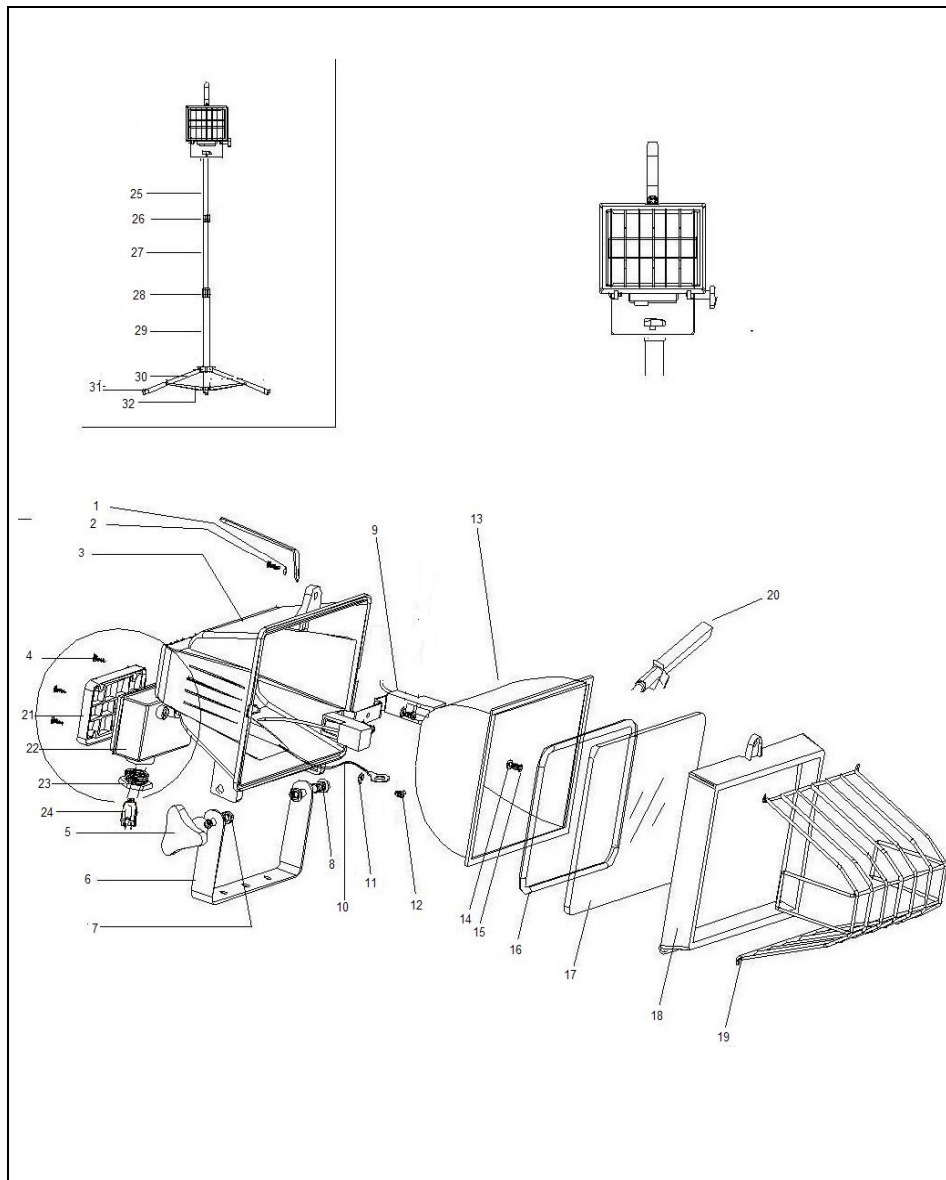

500W single head brackets lamp





NO	PARTS	MATERIAL	posol&request on fac	Quantity
1	M5cushion	A3	Fill white	1
2	M5screw cap	A3	Fill white	1
3	body	ZL102	Spray model	1
4	ST M3*14	A3	Fill white	4
5	plastic screw M6*14	nylon&screw	Black	1
6	fixed stand	Cold roll board	Spray model	1
7	screw capM6	A3	Fill white	2
8	M6*14	A3	Fill white	1
9	lamp holder	118R7S VDE 180° whites weave line		1
10	earth of wire	silica gel wire	yellow&green wire	1
11	Play fil lup M4	A3	Fill white	1
12	M4*6	A3		1
13	reflector	aluminium	True colors	1
14	Tooth fils lup	A3	Fill white	1
15	M4*6	A3	Fill white	1
16	Presses a circle	Silica gel		1
17	glass	177.5*140*5mm R8		1
18	Face lid	ZL102	Spray model	1
19	Net cover	A3	chromeplate	1
20	lamp&the package of lamp	240V/ 400W		
21	the cover of junction box	Enhances nylon	black	1
22	the bottom of junction box	Enhances nylon	black	1
23	hexagonal junction box	Enhances nylon	black	1
24	the wire	H05RN- F 3G1.0 VDE plug		1
25	the top of tripod	Welds take over	Spray model	1
26	32 administer lock set of	PC+ ABS	black	1
27	the middle of tripod	Welds take over	Spray model	1
28	38 administer lock set of	PC+ ABS	black	1
29	Bracket big tube	Welds take over	Spray model	1
30	Bracket foot administers	Welds take over	Spray model	3
31	Bracket foot administers set of	PVC	black	3
32	Bracket flat iron	Cold roll board	Spray model	6

REF: 0206
 220-240~ 50Hz
 R7S J118mm Max.400W

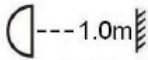

IP54

Ninghai Senrun Electronics Co.,Ltd

Object/part No.	Manufacturer/trade mark	Type/model	Technical data	Mark(s) of conformity
Plug	Ningbo Qiaopu Electric Co., Ltd.	D03-F	250V~, 16A, IP44	VDE 40003059
Supply cord	Ningbo Qiaopu Electric Co., Ltd.	H05RN-F	3X1.0mm ²	VDE 40016395
Internal wire	HONG SHUN WIRE & CABLE FLUOROPLASTIC S FACTORY	HSPFA	PFA, 18AWG, 250°C, 300/500V	VDE 40023021
Lampholder	Yuyao Jinhai Electrical Appliance Co., Ltd.	JH-A	R7S, 250V~, 4A, T250	VDE 40006677
Terminal	Shenzhen Hongyu Electrical Co., Ltd	HYT-500	450V~, 24A, 2.5mm ² , T110	VDE 40020423

halogen lamp:
 Model no.J118 400W
 Rating: 220-240V,50/60HZ,400W,J118
 Service Requested: Energy labelling requirement according to Commission Drective 98/11/EC
 Test method : EN60357:2003+A1:2008+A2:2008

standard : EN 60598-1:2008+A11:2009
 EN 60598-2-5:1998
 EN 60598-2-7:1989+A2:1996+A13: 1997

packing: one pice in a colorbox with BACHMANN logo